

Gearmotor Nomenclature

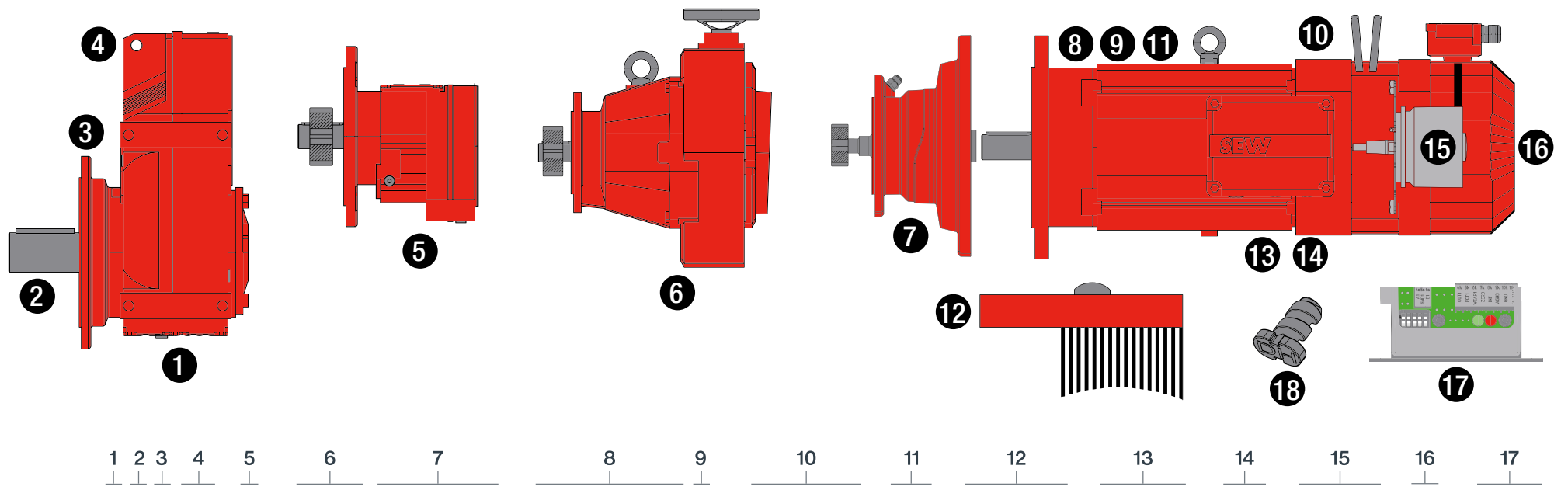

EXAMPLE: KAF47/R D26 AMS80 DRN80M4 / BE1HF/ FF/ MM07/ ASA3/ TH/ EK8C/AL/DUE/DH

1 – Gear Type		2 – Shaft Type		3 – Mounting Flange		4 – Size		5 – Gear Options		6 – Mechanical Variable Speed		7 – Input Adapters		8 – Motor Type / Size	
R/RX	Helical Inline	–	Solid	–	No Flange	R/RX	07 - 167	R..	Secondary Helical Gearbox / Size	D..	VARIMOT® / Size	/A	No Input	DRN..	IE3, Premium Efficiency
F	Helical Offset	A	Keyed Hollow	F	IEC B5 (Through)	F	27 - 157	/R	Reduced Backlash	VU..	VARIGEAR® – U / Size	AD..	Input Shaft / Size	EDRN..	IE3, Hazardous Location Rated
K	Helical Bevel	H	Shrink Disc	Z	IEC B14 (Tapped)	K	19 - 187	B	Rail Holes (F)	VZ..	VARIGEAR® – Z / Size	AMS..	Motor Adapter / Size	DR2S..	IE1, Standard Efficiency
S	Helical Worm	V	Spline	M	Agitator Extension (F, K, or R Unit)	S	37 - 97	B	Feet (K)			AR..	Torque Limiting / Size	DR2L..	Asynchronous Servomotor
W	SPIROPLAN®	T	TorqLOC®			W	10 - 59	F	Feet + Flange (R)			AQSA..	Servo Adapter / Size	56M – 355ML	IEC Frame Size and Stator Length
								/T	Torque Arm (K, S, W)			AQSH..	Servo Adapter / Size		
								/G	Torque Arm Bushing (F)			AT..	Fluid Coupling / Size		

9 – Poles / Synchronous Speed (@60 Hz)	
2	3600 RPM
4	1800 RPM
6	1200 RPM
8	900 RPM
4/2	1800 / 3600 RPM
8/2	900 / 3600 RPM
8/4	900 / 1800 RPM

10 – Mechanical Attachments	
/BE..	Brake / Size
HR	Hand Lever Brake Release
HF	Screw Brake Release
/RS	Single Direction Backstop

11 – Flange / Feet Options	
/FI	IEC Feet
/FG	Integral Motor for Gear Unit
/FF	IEC B5 Flange (Through)
/FT	IEC B14 Flange (Tapped)
/FL	Special Designed Flange
/FM	Integral Motor with IEC Feet for Gear Unit
/FE	IEC B5 Flange (Through) with IEC Feet
/FY	IEC B14 Flange (Tapped) with IEC Feet
/FK	Special Designed Flange with IEC Feet
/FC	NEMA C-Face Flange and Shaft

12 – Built-in Motor Control	
/MM03 - 40	MOVIMOT® Inverter
/MO	MOVIMOT® Options
/MSW	MOVISWITCH®

14 – Thermal Protection	
/TF	PTC Thermistor Sensor
/TH	Bimetallic Switch Thermostat
/PK	PT1000 Platinum Sensor
/PT	PT100 Platinum Sensor

13 – Motor Plug Connectors			
/IS	Integrated Connector		Connector Replaces Terminal Block and Uses Mating Connector in Cover IS = Terminal Block and Mating Connector, ISU = No Mating Connector
/AFL.	Sine® Amphenol		Round 4-Pin Plug Connector for Motor Power and 3-Pin Plug for Brake Power /AFL = 7/8" Motor and Brake, /AFQ = 1-3/8" Motor and 7/8" Brake
/ASE.	Harting Han® 10ES		Cage Clamp Contacts /ASE = Single Latch, /ASB = Double Latch /ASD = MOVIMOT® Power Single Latch, /ASA = MOVIMOT® Power Double Latch
/ACE.	Harting Han® 10E		Crimp Contacts /ACE = Single Latch, /ACB = Double Latch
/AME.	Harting Han® 10B		Crimp Contacts (E and E Modules) /AME = Single Latch, /AMB = Double Latch
/ABE.	Harting Han® 10B		Crimp Contacts (C and E Modules) /ABE = Single Latch, /ABB = Double Latch
/AKE.	Harting Han® 10B		Axial Screw (C Module) and Crimp Contacts (E Module) /AKE = Single Latch, /AKB = Double Latch
/ADE.	Harting Han® 10B		Crimp Contacts (C, C, and E Modules) /ADE = Single Latch, /ADB = Double Latch
/AND.	Harting Han® Q8/0		Crimp Contacts Single Latch
/KD1	INTERCONTEC 723 / 740		Hybrid Cable Connector (MOVILINK® DDI) /KD1 = M23 connector, /KDB = M40 connector

15 – Encoders	
/EK8S, /EV8S	External Incremental Sin/Cos Encoder
/EK8R, /EV8R	External Incremental TTL (RS422) Encoder
/EK8C, /EV8C	External Incremental HTL Encoder
/EK8Z	External Incremental MOVILINK® DDI Encoder
/EI8R	Built-in (Fan-based) Incremental TTL Encoder
/EI8C	Built-in (Fan-based) Incremental HTL Encoder
/EI8Z	Built-in (Fan-based) Incremental MOVILINK® DDI Encoder
/EI71, /EI72, /EI76, /EI7C	Built-in (Fan-based) Incremental HTL Encoder (7 Series) 1 = 1 PPR, 2 = 2 PPR, 6 = 6 PPR, C = 24 PPR
/AK8W, /AV8W	External Absolute Sin/Cos and RS485 Encoder
/AK8Y, /AV8Y	External Absolute Sin/Cos and SSI Encoder
/AK8H, /AV8H	External Absolute Sin/Cos and HIPERFACE® Encoder
/AK8Z	External Absolute MOVILINK® DDI Encoder
/EK8A	Mounting Adapter for SEW-EURODRIVE Encoder
/XV.A	Mounting Adapter for Third-party Encoder
/XV..	Mounted Third-party Encoder

16 – Ventilation	
/V	Forced Cooling Fan
/Z	Increased Inertia Flywheel Fan
/LN	Low Noise Fan Guard
/C	Fan Guard with Canopy
/AL	Aluminum Fan
/OL	Non-Vented (Closed B-Side)
/U	Non-vented (no Fan)

17 – Condition Monitoring	
/DUO	Oil Age Monitoring
/DUV	Vibration Sensor
/DUE	Brake Function and Wear Monitoring

18 – Motor Options	
/DH	Motor Condensation Drain Hole Plug
/RI	Reinforced Winding Insulation
/RI2	Reinforced Insulation with Partial Discharge Resistance
/2W	Motor Rotor Shaft Extension from B-Side
/CID2	Hazardous Location Class I, Division 2, Group A/B/C/D (Gas)
/CIID2	Hazardous Location Class II, Division 2, Group F/G (Dust)
/CICIID2	Hazardous Location Class I, Division 2, Group A/B/C/D + Class II, Division 2, Group F/G (Gas or Dust)
/NS	Motor Bearing Lubrication Port
/ERF	Reinforced A-Side Motor Bearing
/NIB	Insulated B-Side Motor Bearing
/DI	MOVILINK® DDI

NOTE: This poster shows the most common gearmotor options and their associated nomenclature. For complete information, consult the appropriate product catalog or an SEW-EURODRIVE representative.

Midwest Region SEW-Eurodrive, Inc 2001 West Main St. Troy, OH 45373 P: (937) 335-0036 cstroy@seweurodrive.com	Northeast Region SEW-Eurodrive, Inc 2107 High Hill Rd. Bridgeport, NJ 08014 P: (856) 467-2277 csbridgeport@seweurodrive.com	Southeast Region (U.S. HQ) SEW-Eurodrive, Inc 220 Finch Rd. Wellford, SC 29385 P: (864) 439-7537 cslyman@seweurodrive.com	Southwest Region SEW-Eurodrive, Inc 202 W. Danieldale Rd. DeSoto, TX 75115 P: (214) 330-4824 csdallas@seweurodrive.com	Western Region SEW-Eurodrive, Inc 30599 San Antonio St. Hayward, CA 94544 P: (510) 487-3560 cshayward@seweurodrive.com	Large Industrial Gears SEW-Eurodrive, Inc 148 Finch Rd. Wellford, SC 29385 P: (864) 439-8792 igssorders@seweurodrive.com
---	---	---	--	--	--